



2



1



2

PRICE GUIDE: \$495.00 Per Week

### Walk to the Cafes and the Beach

This fabulous two bedroom Mornington abode overlooking Mornington is only a short stroll to both Main Street shopping and restaurant strip, and arguably Port Phillip bay's best beach - Mill's beach.

Featuring a striking bluestone feature wall and huge sliding doors that open from the living space to a broad balcony with aspects to the town centre. A spacious, bright renovated kitchen includes dishwasher, gas hotplates and oven.

Other features include, updated bathroom, separate laundry, split system heating and cooling, gas log fire, ducted heating, beautiful hardwood floors, large bedrooms with built in robes, spacious private rear courtyard and single garage with remote door.



**Victoria Madeley**  
0411 171 168



**Elizabeth Alessandrello**  
0414602129



OFFICE

PO BOX 4123, MOUNT ELIZA, VIC

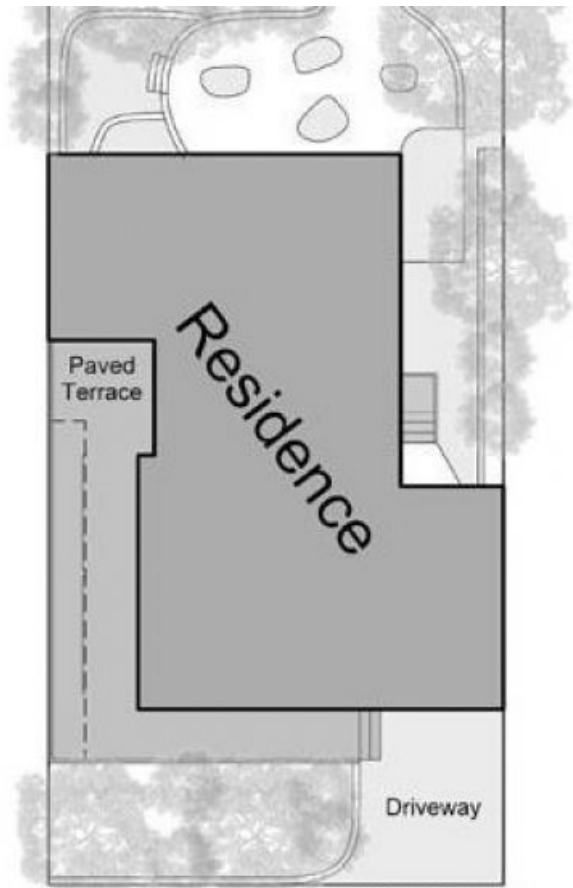
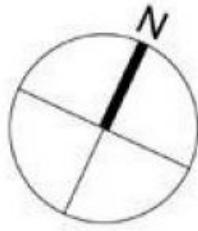

Site Plan



Floor Plan



OFFICE