



4



3



2

PRICE GUIDE: \$750.00 Per week

Luxury Coastal Living

Luxury coastal living takes centre stage with this 12-month young residence, minutes to the beach and steps to parkland. This modern four bedroom home is a symphony of style on a low-maintenance block positioned for a lifestyle of leisure.

Stroll to Dunns Road Reserve and playground 200m away with pets and children, and enjoy easy access to schools, shops and nature. The interior showcases quality finishes throughout and a zoned floorplan with a desirable ground-floor master suite central to the design.

Two living rooms offer space to unwind and connect, while floor-to-ceiling ceramic-tiled bathrooms speak to the style-seeker at heart. Double ovens, a 900mm induction cooktop and an integrated Bosch dishwasher affirm the culinary quality in the gourmet stone kitchen.

Other features include a remote double garage with internal entry, secondary bedrooms with built-in robes, a powder room, square-set c



Victoria Madeley
0411 171 168



Elizabeth Alessandrello
0414602129



OFFICE

PO BOX 4123, MOUNT ELIZA, VIC



Internal living area
approx: 20 squares

Garage area
approx: 4 squares

Porch and alfresco
approx: 2 squares

Total area
approx: 26 squares

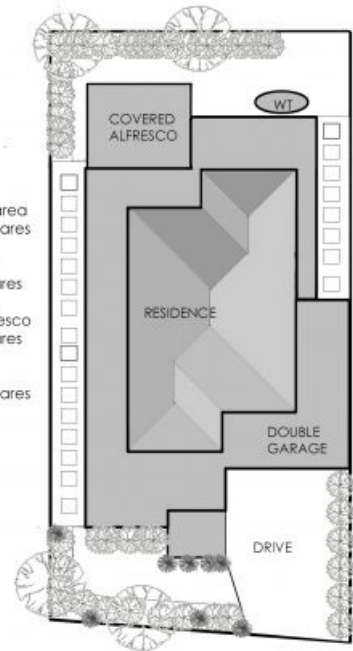

5A Acacia Street, Mount Martha

Produced by DND Floorplans

This floorplan is a guide only and no warranty is given to its accuracy in dimensions. Purchasers are advised to carry out their own investigations



OFFICE